

END POST
ITEM NO. 707-03.02

LINE POST

LINE POST

LINE POSTS
ITEM NO. 707-03.01

* NOTE REGARDING TIE WIRES:
NO. 9 GAUGE DOUBLE STRAND GALVANIZED
TIE WIRE TWISTED TO SINGING TIGHTNESS,
DOUBLE WRAPPED AROUND POSTS.

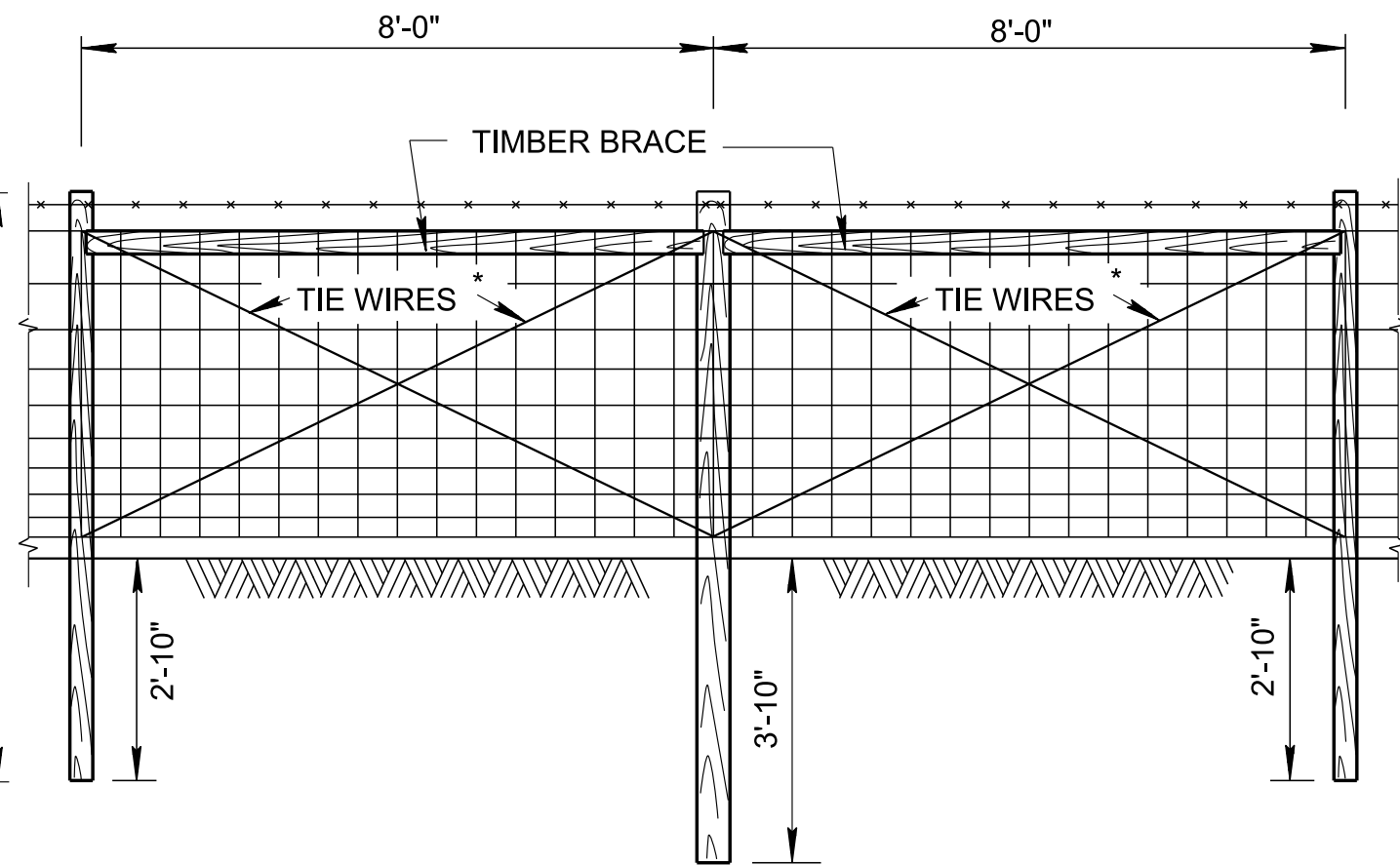

BRACED LINE POST
ITEM NO. 707-03.02

BRACED LINE POSTS ARE REQUIRED AT 324'
MAXIMUM INTERVALS FROM THE BEGINNING
CORNER FOR THE FIRST ROLL. BRACED LINE
POSTS ARE REQUIRED AT 330' MAXIMUM
INTERVALS AFTER THE FIRST ROLL FROM
THE BEGINNING CORNER. THIS SPACING WILL
PERMIT A 6' LENGTH OF FABRIC TO EXTEND
BEYOND THE BRACED LINE POST ASSEMBLY
FOR ATTACHING THE STRETCHING DEVICE
AND FOR SPLICING TO THE NEXT ROLL.

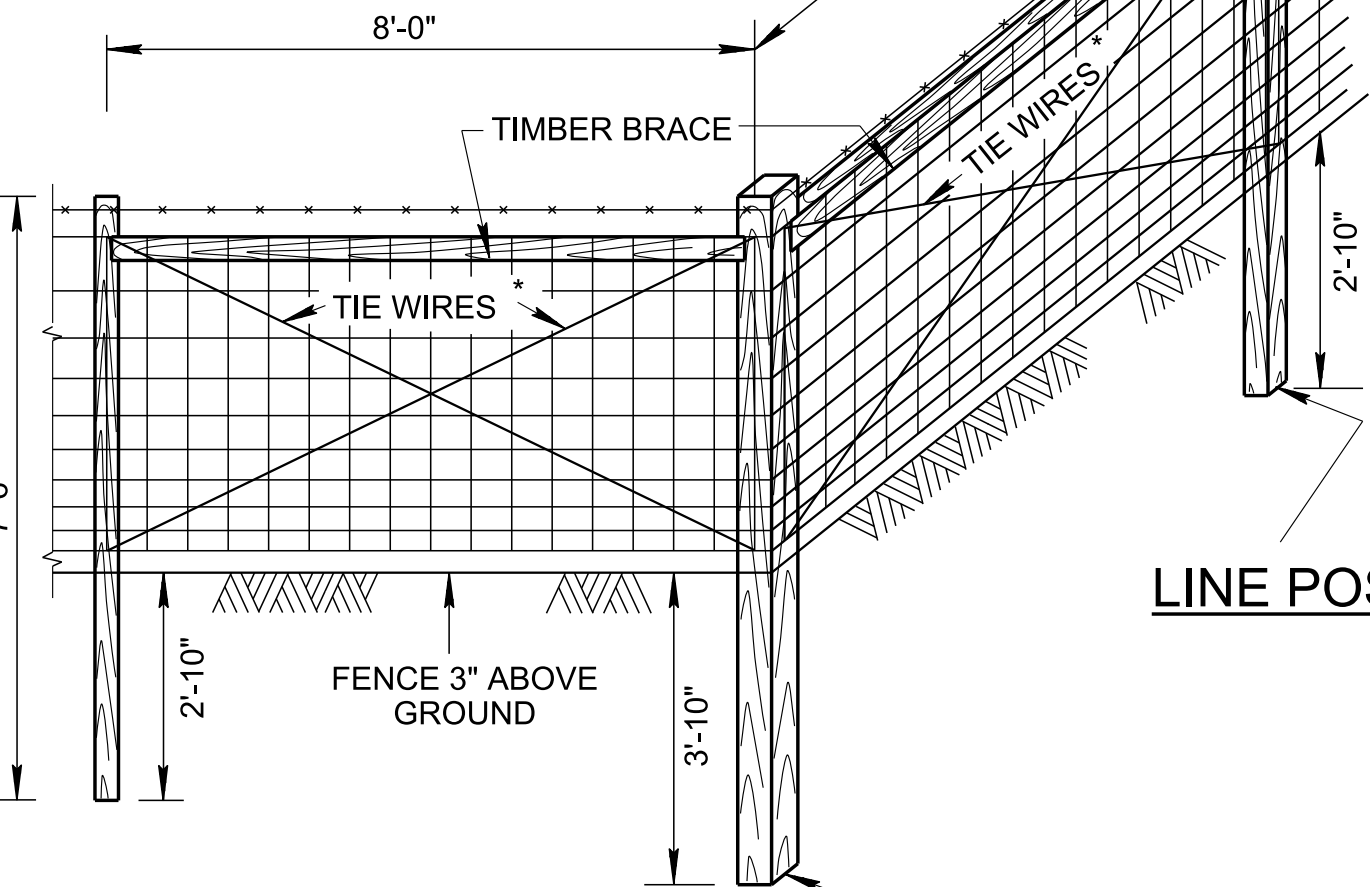

CORNER POST
ITEM NO. 707-03.02

LINE POST

- REV. 7-1-72: CHANGED DEPARTMENT NAME.
- REV. 12-7-75: ADDED ITEM NO'S FOR END BRACED LINE AND CORNER POST.
- REV. 1-1-76: CHANGED DRAWING NUMBER FROM RD-F-10(68), (SHEET 2) TO S-F-10a.
- REV. 2-25-77: DELETED BARED WIRE AT BOTTEM OF FENCE. CHANGED POST SPACING ON BRACED LINE POSTS AND CORNER POSTS FROM 10' TO 8'. ADDED NOTES REGARDING FENCING OVER DITCHES AND IRREGULAR TERRAIN.
- REV. 7-17-81: CHANGED ITEM NO. TO AGREE WITH NEW SPECIFICATION BOOK.
- REV. 1-24-08: REDREW SHEET AND CHANGED LENGTH OF ALL FENCE POSTS. ADDED NOTE(H).
- REV. 6-1-09: REMOVED TIE WIRES BETWEEN LINE POSTS. MODIFIED GENERAL NOTE(A) ADDED GENERAL NOTE(B). REVISED LINE POST SPACING.
- REV. 11-15-17: CHANGED FONT. CORRECTED MISSPELLINGS. CORRECTED GENERAL NOTE LETTERING. CORRECTED PAY ITEM DESCRIPTION. REWORKED THE BRACED LINE POST NOTE REGARDING MAXIMUM INTERVALS.

ALWAYS PUT THE WIRE ON THE OUTSIDE OF THE POST ON THE CURVE SO THAT IT PULLS AGAINST THE FENCE POSTS.

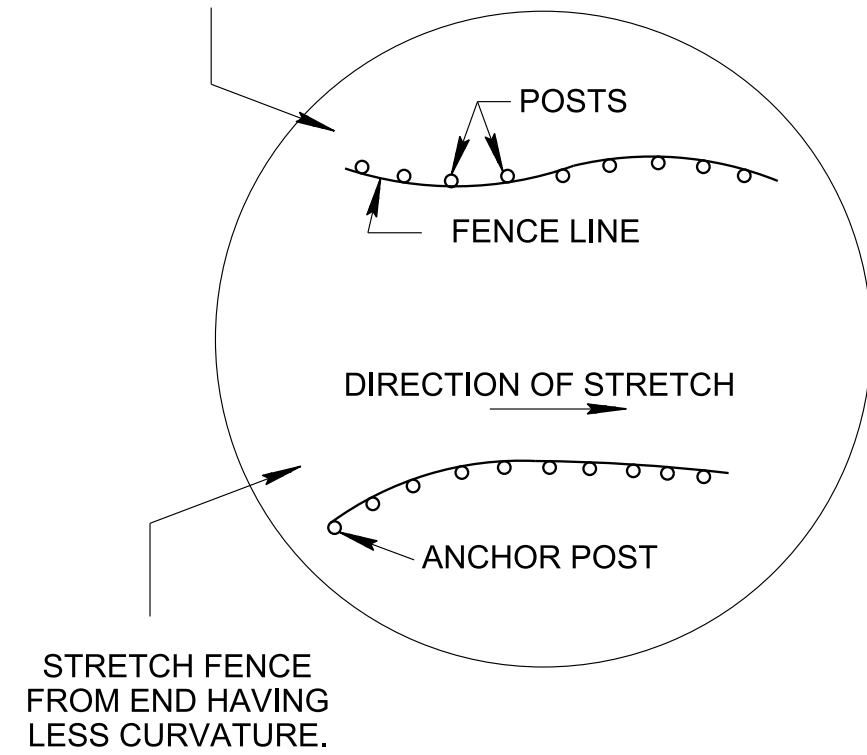

DETAIL OF FENCING ON CURVE

FENCE POST DIMENSIONS			
TYPE	SIZE		LENGTH
	ROUND (DIA.)	SQUARE (EDGE WIDTH)	
LINE POST	3½"	3½"	7'-6"
BRACED LINE POST			
CORNER POST	5"	5"	8'-6"
END POST			
TIMBER BRACE	3½"	3½"	7'-9"

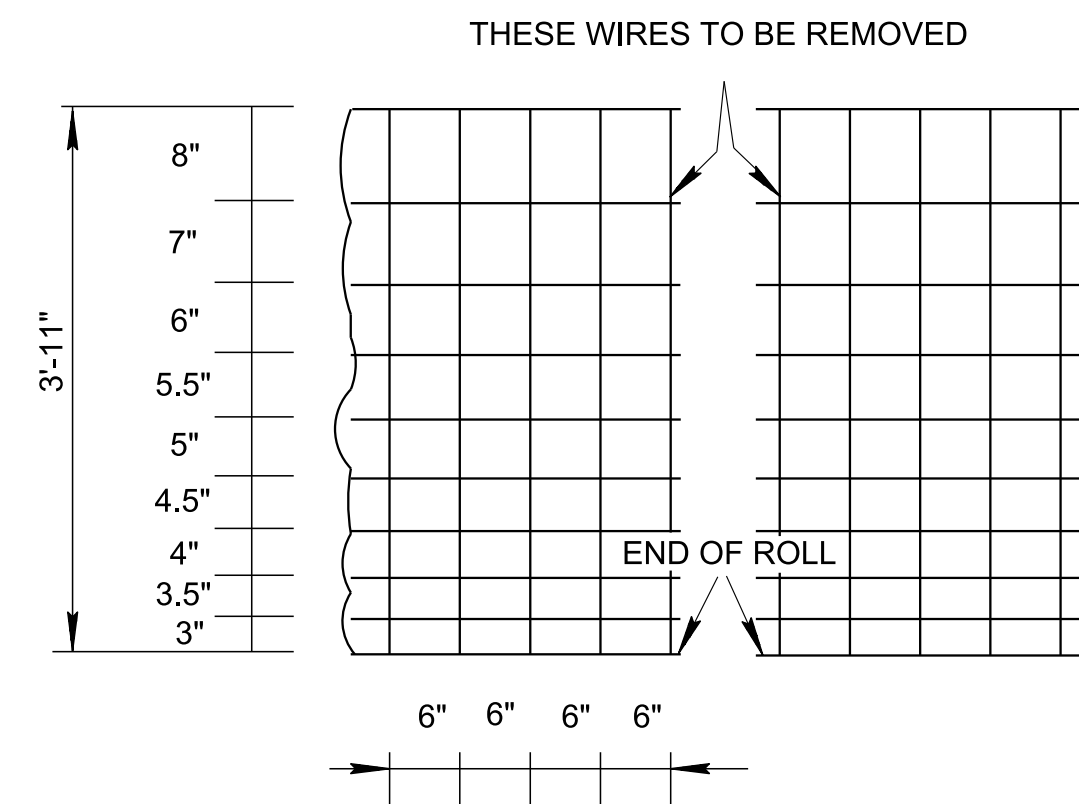

FARM FENCE WIRE DETAILS

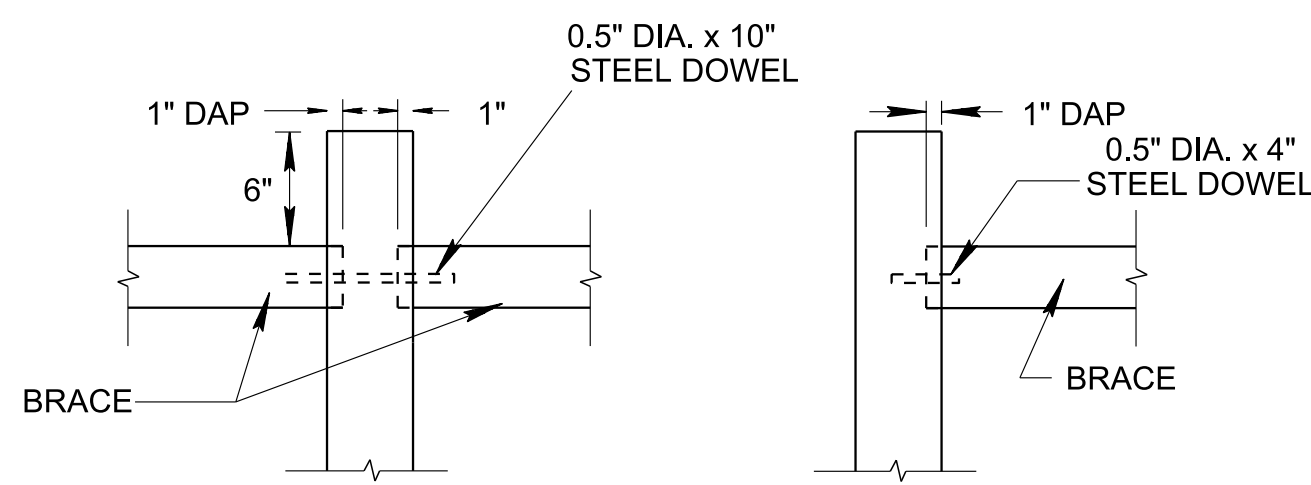

LINE POST

END POST

TIMBER BRACING DETAILS

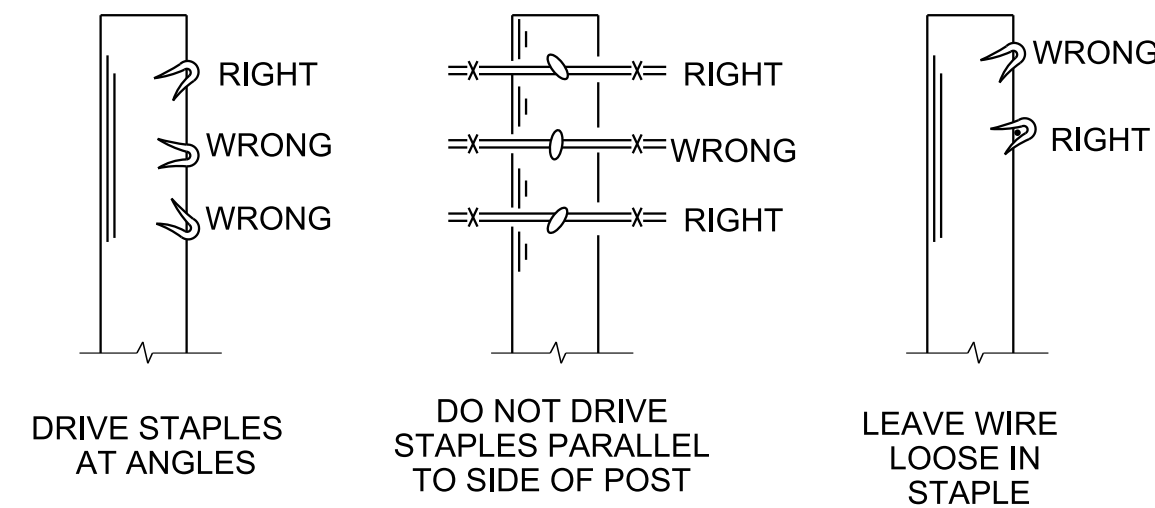

STAPLING DETAILS

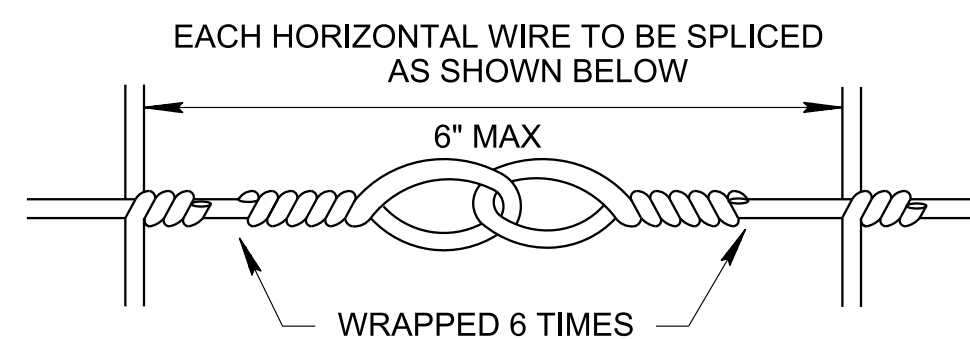

SPLICE DETAIL FOR FENCE

GENERAL NOTES

- (A) GALVANIZED STEEL WOVEN WIRE MEETING THE REQUIREMENTS OF ASTM A-116 FOR NO. 11 FARM, DESIGN NO. 1047-6-11, CLASS III COATING OR GALVANIZED HIGH TENSILE STRENGTH STEEL WOVEN WIRE MEETING THE REQUIREMENTS OF ASTM A-116 FOR NO. 12½ FARM DESIGN, CLASS III COATING EXCEPT THAT THE TOP AND BOTTOM STRAND SHALL BE 10½ GAUGE AND THE YIELD STRENGTH SHALL BE EQUIVALENT TO NO. 11 FARM DESIGN 1047-6-11.
- (B) THE BARBED WIRE SHALL CONSIST OF 2 NO. 12½ GAUGE TWISTED STEEL LINE WIRES WITH NO. 14 GAUGE 4-POINT BARBS SPACED NOT MORE THAN 5 IN. APART. IT MAY BE EITHER GALVANIZED OR ALUMINUM COATED. THE GALVANIZED WIRE SHALL MEET THE REQUIREMENTS OF ASTM A-121, CHAIN LINK FENCE GRADE. AT THE OPTION OF THE CONTRACTOR, HIGH TENSILE STRENGTH WIRE WITH BARB SPACINGS AS DESIGNATED ABOVE, MAY BE USED. IF THE CONTRACTOR ELECTS TO FURNISH HIGH TENSILE STRENGTH WIRE, IT SHALL MEET THE REQUIREMENTS OF ASTM A-121, CHAIN LINK FENCE GRADE FOR THE RESPECTIVE WIRE SIZE.
- (C) USE EITHER ROUND POST AND ROUND BRACING OR SQUARE POST AND SQUARE BRACING.
- (D) USE 1.5" LONG NO.9 GAUGE GALVANIZED STAPLES FOR TIMBER POSTS.
- (E) AT ABRUPT CHANGES IN GRADE OR ALIGNMENT STAPLE EVERY LINE WIRE. AT LINE POSTS STAPLE EVERY LINE WIRE IN THE TOP HALF AND ALTERNATE LINE WIRE IN THE BOTTOM HALF. SEE STAPLING DETAILS.
- (F) SEE STANDARD DRAWING S-FG-20 FOR DETAILS OF FENCING OVER DITCHES AND AT OTHER ABRUPT DEPRESSIONS.
- (G) SEE STANDARD SPECIFICATIONS, SUB-SECTION 707.05 REGARDING FURNISHING AND PLACING ADDITIONAL BRACED LINE POSTS WHERE TERRAIN IS IRREGULAR.
- (H) SEE S-F-10C FOR FENCING AT BRIDGES AND CULVERTS.
- (I) IF BARBED WIRE IS BEING USED FOR STOCK FENCE, IT IS TO BE FIVE STRAND BARBED WIRE AND THE TOP STRAND OF BARBED WIRE IS TO BE PLACED 54" ABOVE THE GROUND. THE BOTTOM STRAND OF BARBED WIRE IS TO BE PLACED NOT LESS THAN 6" ABOVE THE GROUND. THE NEXT TO THE BOTTOM STRAND OF BARBED WIRE IS TO BE PLACED NOT LESS THAN THAT 15" ABOVE THE GROUND. PAYMENT WILL BE MADE UNDER ITEM NO. 707-03.14, FIVE STRAND BARBED WIRE FENCE, PER LINEAR FOOT.
- (J) PAYMENT WILL BE MADE UNDER:
ITEM NO. 707-03.01 STOCK FENCE PER LIN. FT.
ITEM NO. 707-03.02 END, BRACED LINE, CORNER POST ASSEMBLY(STOCK FENCE) PER EACH

MINOR REVISION -- FHWA
APPROVAL NOT REQUIRED.

STATE OF TENNESSEE
DEPARTMENT OF
TRANSPORTATION

STANDARD
RIGHT-OF-WAY
STOCK FENCE WITH
TIMBER POSTS